



SINCE 1968

2 IN 1
CORDLESS
BLENDER

INSTRUCTION
MANUAL

Please retain instructions for future reference.

Safety Instructions

When using electrical appliances, basic safety precautions should always be followed.

Check that the voltage indicated on the rating plate corresponds with that of the local network before connecting the appliance to the mains power supply.

Children aged from 8 years and people with reduced physical, sensory or mental capabilities or lack of experience and knowledge can use this appliance, only if they have been given supervision or instruction concerning use of the appliance in a safe way and understand the hazards involved.

Children should be supervised to ensure that they do not play with the appliance.

Unless they are older than 8 and supervised, children should not perform cleaning or user maintenance.

This appliance is not a toy.

If the charging cable, plug or any part of the appliance is malfunctioning or if it has been dropped or damaged, cease using the product immediately to avoid potential injury.

This appliance contains no user serviceable parts, only a qualified electrician should carry out repairs. Improper repairs may place the user at risk of harm.

Keep the appliance and its charging cable out of the reach of children.

Keep the appliance out of the reach of children when it is switched on or cooling down.

Keep the appliance and its charging cable away from heat or sharp edges that could cause damage.

Keep hands, fingers, hair and any loose clothing away from the rotating tools of the appliance.

Do not immerse the electrical components of this appliance in water or any other liquid.

Do not operate the appliance with wet hands.

Do not leave the appliance unattended whilst connected to the mains power supply.

Do not remove the appliance from the mains power supply by pulling the charging cable; switch it off and remove the plug by hand.

Do not pull or carry the appliance by its charging cable.

Do not use the appliance if it has been dropped, if there are visible signs of damage or if it is leaking.

Do not use the appliance for anything other than its intended use.

Do not use any accessories other than those supplied.

Do not use any damaged accessories.

Do not use this appliance outdoors.

Do not store the appliance in direct sunlight or in high humidity conditions.

Do not dry blend ingredients; always add a small amount of liquid.

Do not overload the appliance as the mixture level may rise during blending.

Do not touch any moving parts on this appliance during use, as this could cause injury.

Do not touch any sections of the appliance that may become hot during use, as this could cause injury.

Do not use broken or loose cutting or rotating blades.

Always unplug the appliance after use and before any cleaning or user maintenance.

Always ensure that the appliance has cooled fully after use before performing any cleaning or maintenance.

Use of an extension cord with the appliance is not recommended.

This appliance should not be operated by means of an external timer or separate remote control system.

This appliance is intended for domestic use only. It should not be used for commercial purposes.

WARNING: Do not touch sharp blades.

Rechargeable Batteries (Non-removable)

The supply terminals are not to be short-circuited.

In the event of a battery and cell leaking, do not allow the liquid to come in contact with the skin or eyes. If contact has been made, wash the affected area with copious amounts of water and seek medical advice.

Secondary cells and batteries need to be charged before use.

After extended periods of storage, it may be necessary to charge and discharge the cells or batteries several times to obtain maximum performance.

Keep batteries out of the reach of children.

Do not crush, puncture, dismantle or otherwise damage batteries.

Do not store above 60 °C.

Avoid storage in direct sunlight.

Do not dispose of exhausted batteries in household waste.

Do not expose the batteries to heat or fire as they may explode.

Once the batteries have been exhausted, dispose of the product at a local recycling station. Contact the local government offices for further details.

This product is fitted with a 2000 mAh Li-ion battery (non-removable).

Care and Maintenance

STEP 1: Switch off and unplug the blender from the mains power supply before performing any cleaning or user maintenance.

STEP 2: Wipe the blender motor unit with a soft, damp cloth and allow to dry thoroughly.

STEP 3: Wash all of the accessories in warm, soapy water, then rinse and dry thoroughly.

Never touch the stainless steel blades; using extreme caution, clean the blades with a brush and dry carefully.

Do not immerse the blender motor unit in water or any other liquid.

Do not use harsh or abrasive detergents or scourers to clean the blender, as this could cause damage.

The blender is not suitable for use in a dishwasher.

NOTE: The blender should be cleaned after each use.

WARNING: Handle the attachments with care, as the blades are sharp. Exercise caution when attaching, removing, cleaning or storing the attachments.

Description of Parts

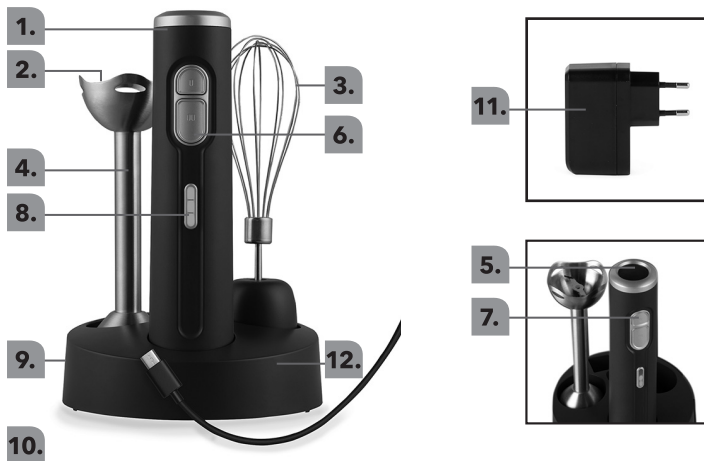

- | | |
|---------------------------------------|-------------------------------|
| 1. 2 in 1 Cordless Blender motor unit | 7. Low speed button |
| 2. Stainless steel blades | 8. Indicator lights |
| 3. Whisk attachment | 9. Charging port |
| 4. Blending attachment | 10. USB Type-C charging cable |
| 5. Unlock button | 11. Charging adaptor |
| 6. High speed button | 12. Storage base |

Instructions for Use

Before First Use

STEP 1: Clean the blender and its accessories following the instructions in the section entitled 'Care and Maintenance'.

STEP 2: Place the blender motor unit onto a stable, heat-resistant surface, at a height that is comfortable for the user.

NOTE: When using the blender for the first time, a slight odour may be emitted. This is normal and will soon subside. Allow for sufficient ventilation around the blender.

WARNING: Do not immerse the blender motor unit in water or any other liquid. Never use harsh or abrasive cleaning detergents or scourers to clean the blender or its accessories, as this could cause damage.

Charging the 2 in 1 Cordless Blender

STEP 1: Open the charging port on the blender motor unit and insert the USB Type-C end of the USB charging cable.

STEP 2: Insert the USB end of the USB charging cable into the charging adaptor.

STEP 3: Plug the charging adaptor into the mains power supply; the indicator lights will flash during charging and will stop when the battery is fully charged. See the section entitled 'Indicator Lights' for further details.

NOTE: The blender comes supplied with approximately 30 % charge in the batteries. However, for best performance, it is recommended to fully charge the blender before first use; this will take approximately 5 hours.

The blender can also be charged whilst stored in its storage base.

CAUTION: The blender should only be charged using the adaptor and cable provided (DZ012ELU050200V). Do not use the adaptor or cable with any other appliance.

Using the 2 in 1 Cordless Blender

All attachments must be securely fitted before use; do not attempt to remove them until the attachment has stopped moving.

STEP 1: Carefully secure the required attachment to the blender motor unit by aligning the tabs and twisting until it clicks into place.

STEP 2: Place the food to be prepared into a suitable bowl; do not overfill.

STEP 3: Insert the attachment into the bowl.

STEP 4: Holding the bowl steady, press the unlock '**UNLOCK**' button on top of the blender motor unit. The indicator lights will flash to indicate that the blender is ready to use.

STEP 5: To blend or whisk the ingredients, press and hold either the low 'I' or high 'II' speed button on top of the blender motor unit.

STEP 6: Blend the ingredients by gently lowering and raising the blender motor unit in and out the bowl. Whisk the ingredients by slowly rotating the whisk attachment in a clockwise direction to avoid splashing.

STEP 7: Stop the process by releasing the relevant speed button.

STEP 8: Make sure that the attachment has completely stopped before removing from the blender motor unit.

NOTE: If a speed button is not pressed within 3 seconds the blender will not turn on and the unlock '**UNLOCK**' button will need to be pressed again. During use the speed button must be held for the duration of operation.

CAUTION: Switch off the blender before adding or removing food from the bowl.

WARNING: Do not operate the blender without food as this can cause damage.

Maximum operation time is 1 minute. Allow to cool for 5 minutes before using the blender again; this will prevent damage to the motor.

Indicator Lights

Battery Remaining Indicator

X X X	66-100 % charge
X X	33-65 % charge
X	20-30 % charge
X (Flashing)	<20 % charge and the blender needs to be charged

Charging Indication (Indicator Lights Whilst Charging)

X X X (Flashing)	<33 % charge
X (Solid) X X (Flashing)	33-65 % charge
X X (Solid) X (Flashing)	66-99 % charge
X X X (Solid)	>99 % charge

Motor Cut-off Indication

The motor has an automatic protection system that will not allow overloading or overheating. If the load is too large, or the blender is used for too long, it will automatically shut off. If the blender senses an overload situation, all 3 indicator lights will flash 5 times and the blender will turn off. Release the speed button and the indicator lights will turn off. Reduce the load on the blender, allow it to rest for 15 minutes and then resume use.

Troubleshooting

Problem	Possible Cause	Solution
The blender will not operate.	The blender is not charged.	Charge the blender following the instructions in the section entitled 'Charging the 2 in 1 Cordless Blender'.
The attachment will not move when in contact with ingredients.	The ingredients are hard vegetables such as potato, carrot and turnip, making it difficult for the blender to blend.	Only blend ingredients such as cooked vegetables or soft fruit.

Storage

Reassemble the blender.

Check that the blender is cool, clean and dry before storing in a cool, dry place.

Specifications

Product code: PT5394

Product output: 10.8 V \equiv 200 W

Charger input: 100-240 V ~ 50/60 Hz 0.5 A Max

Charger output: 5 V \equiv 2.0 A 10 W

Average active efficiency: $\geq 78.70\%$

Efficiency at low load (10 %): $\geq 73\%$

No-load power consumption: $\leq 0.1\text{ W}$

UK PLUGS ONLY

Connection to the mains

Please check that the voltage indicated on the product corresponds with your supply voltage.

Important

As the colours in the mains lead of this appliance may not correspond with the coloured markings identifying the terminals in your plug, please proceed as follows:

The wires in the mains lead are coloured in accordance with the following code:

Blue Neutral (N)

Brown Live (L)

Green/Yellow Earth (\perp)

FOR UK USE ONLY - Plug fitting details
(where applicable).

The wire coloured BLUE is the NEUTRAL and must be connected to the terminal marked N or coloured BLACK.

The wire coloured BROWN is the LIVE wire and must be connected to the terminal marked L or coloured RED.

The wire coloured GREEN/YELLOW must be connected to the terminal marked with the letter E or marked \perp .

On no account must either the BROWN or the BLUE wire be connected to the EARTH terminal (\perp).

Always ensure that the cord grip is fastened correctly.

The plug must be fitted with a fuse of the same rating already fitted and conforming to BS 1362 and be ASTA approved.

If in doubt consult a qualified electrician who will be pleased to do this for you.

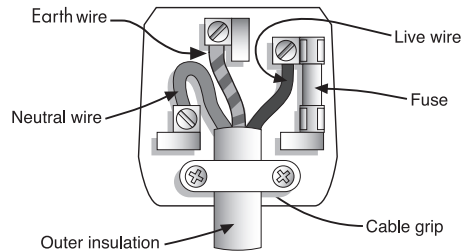

Non-rewireable mains plug

If your appliance is supplied with a non-rewireable plug fitted to the mains lead and should the fuse need replacing, you must use an ASTA approved one (conforming to BS 1362 of the same rating).

If in doubt, consult a qualified electrician who will be pleased to do this for you.

If you need to remove the plug - DISCONNECT IT FROM THE MAINS and then cut it off the mains lead and immediately dispose of it safely. Never attempt to reuse the plug or insert it into a socket outlet as there is a danger of an electric shock.

**UP Global Sourcing UK Ltd.,
Victoria Street, Manchester OL9 0DD. UK.
Edmund-Rumpler Straße 5, 51149 Köln. Germany.**

If this product does not reach you in an acceptable condition please contact our Customer Services Department at **customercare@upgs.com**

Please have your delivery note to hand as details from it will be required.

If you wish to return this product please return it to the retailer from where it was purchased with your receipt (subject to their terms and conditions).

Guarantee

All products purchased as new carry a manufacturer's guarantee; the time period of the guarantee will vary dependent upon the product. Where reasonable proof of purchase can be provided, Petra will provide a standard 12 month guarantee with the retailer from the date of purchase. This is only applicable when products have been used as instructed for their intended, domestic use. Any misuse or dismantling of products will invalidate any guarantee.

Under the guarantee, we undertake to repair or replace free of any charge any parts found to be defective. In the event that we cannot provide an exact replacement, a similar product will be offered or the cost refunded. Any damages from daily wear and tear are not covered by this guarantee, nor are consumables such as plugs, fuses etc.

Please note that the above terms and conditions may be updated from time to time and we therefore recommend that you check these each time you revisit the website.

Nothing in this guarantee or in the instructions relating to this product excludes, restricts or otherwise affects your statutory rights.

Disposal of Waste Batteries and Electrical and Electronic Equipment



This symbol on the product, its batteries or its packaging means that this product and any batteries it contains must not be disposed of with household waste. Instead, it is the user's responsibility to hand this over to an applicable collection point for the recycling of batteries and electrical and electronic equipment. This separate collection and recycling will help to conserve natural resources and prevent potential negative consequences for human health and the environment due to the possible presence of hazardous substances in batteries and electrical and electronic equipment, which could be caused by inappropriate disposal. Some retailers provide take-back services which allow the user to return exhausted equipment for appropriate disposal.

It is the user's responsibility to delete any data on electrical and electronic equipment prior to disposal. For more information about where to drop batteries, electrical and electronic waste off, please contact the local city/municipality office, household waste disposal service, or the retailer.



Manufactured by:
UP Global Sourcing UK Ltd.,
Victoria Street, Manchester OL9 0DD. **UK.**
Edmund-Rumpler Straße 5, 51149 Köln. **Germany.**

MADE IN CHINA.

www.petra-electric.com

©Petra Trademark. All rights reserved.

CD160123/MD210323/V2

