



WARNING: Some popcorn kernels may not expand or puff properly during operation. Exercise caution and avoid immediate contact with the popcorn kernels, as they will be very hot. Do not remove the lid whilst the popcorn maker is turned on and in operation. Do not shake the popcorn maker whilst it is in operation.

Storage

Check that the popcorn maker is cool, clean and dry before storing in a cool, dry place.

Never wrap the power supply cord tightly around the popcorn maker; wrap it loosely to avoid damage.

Specifications

Product code: EK6224 / PT6224

Input: 220–240 V ~ 50–60 Hz

Output: 400–500 W

Topping suggestions

Sugar

Salt

Melted butter

Toffee sauce

Caramel sauce

Melted chocolate

Sweets

Sprinkles

Salted nuts

Cheese seasoning



Disposal of Waste Batteries and Electrical and Electronic Equipment



This symbol on the product, its batteries or its packaging means that this product and any batteries it contains must not be disposed of with household waste. Instead, it is the user's responsibility to hand this over to an applicable collection point for the recycling of batteries and electrical and electronic equipment. This separate collection and recycling will help to conserve natural resources and prevent potential negative consequences for human health and the environment due to the possible presence of hazardous substances in batteries and electrical and electronic equipment, which could be caused by inappropriate disposal. Some retailers provide take-back services which allow the user to return exhausted equipment for appropriate disposal. **It is the user's responsibility to delete any data on electrical and electronic equipment prior to disposal.** For more information about where to drop batteries, electrical and electronic waste off, please contact the local city/municipality office, household waste disposal service, or the retailer.

User manual

Stir popcorn maker

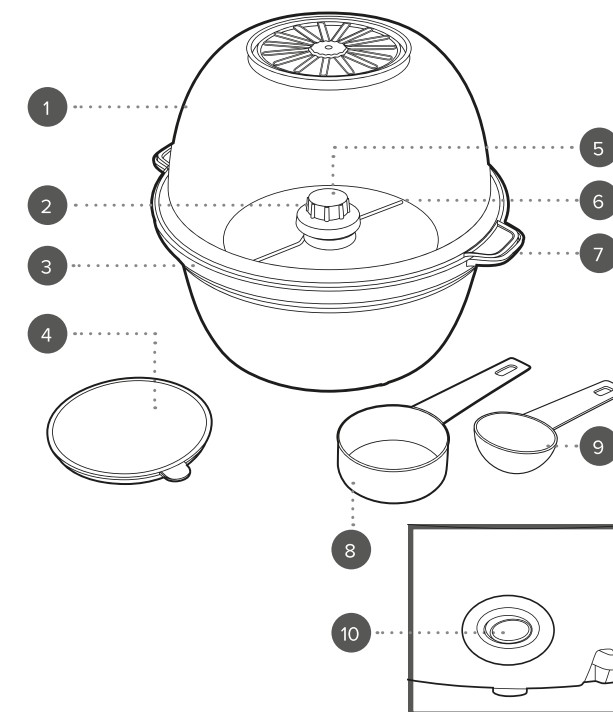

1. Lid/serving bowl
2. Stirring knob
3. Popcorn maker main unit
4. Vent cap
5. Cooking plate

6. Rotating stirrer
7. Cool-touch handles
8. Large measuring spoon (50 g)
9. Small measuring spoon (1 tbsp)
10. On/off switch

Manufactured by:
Ultimate Products UK Ltd.,
Victoria Street, Manchester OL9 0DD. **UK.**
Ultimate Products Europe Ltd.,
19 Baggot Street Lower, Dublin D02 X658. **ROI.**

MADE IN CHINA.

CD290424/MD000000/V1

Please retain instructions for future reference.

SAFETY INSTRUCTIONS

- When using electrical appliances, basic safety precautions should always be followed.
- Check that the voltage indicated on the rating plate corresponds with that of the local network before connecting the appliance to the mains power supply.
- This appliance can be used by children aged from 8 years and above and persons with reduced physical, sensory or mental capabilities and knowledge, if they have been supervised/instructed and understand the hazards involved.
- Children shall not play with the appliance.
- Children should not perform cleaning or user maintenance, unless they are older than 8 and supervised.
- This appliance is not a toy.
- If the power supply cord, plug or any part of the appliance is malfunctioning or if it has been dropped or damaged, cease using the product immediately to avoid potential injury.
- This appliance contains no user serviceable parts, only a qualified electrician should carry out repairs. Improper repairs may place the user at risk of harm.
- Keep the appliance and its power supply cord out of the reach of children.
- Keep the appliance out of the reach of children when it is switched on or cooling down.
- Keep the appliance and its power supply cord away from heat or sharp edges that could cause damage.
- Keep the power supply cord away from any parts of the appliance that may become hot during use.
- Keep the appliance away from other heat emitting appliances.
- Do not allow the power supply cord to hang over worktops, touch hot surfaces or become twisted.
- Do not immerse the electrical components of the appliance in water or any other liquid.
- Do not operate the appliance with wet hands or if any connections are wet.
- Do not leave the appliance unattended whilst connected to the mains power supply.
- Do not remove the appliance from the mains power supply by pulling the cord; switch it off and remove the plug by hand.

- Do not pull or carry the appliance by its power supply cord.
- Do not use the appliance for anything other than its intended use.
- Do not use any accessories other than those supplied.
- Do not use this appliance outdoors.
- Do not store the appliance in direct sunlight or in high humidity conditions.
- Do not move the appliance whilst it is in use.
- If this appliance falls or accidentally becomes immersed in water, unplug it from the wall outlet immediately. Do not reach into the water.
- Do not use broken, damaged, or loose attachments.
- Switch off the appliance and disconnect it from the mains power supply before changing or fitting attachments.
- Always unplug the appliance after use and ensure it has cooled fully before performing any cleaning, user maintenance or storing away.
- This appliance should not be operated by means of an external timer or separate remote control system.
- Use of an extension cord with the appliance is not recommended.
- Always use the appliance on a stable, heat-resistant surface, at a height that is comfortable for the user.
- This appliance is intended for domestic use only. It should not be used for commercial purposes.



CAUTION: Hot surface – do not touch the hot section or heating components of the appliance.



WARNING: Keep the appliance away from flammable materials.

Care and maintenance

Switch off and unplug the popcorn maker from the mains power supply and allow to cool fully before performing any cleaning or user maintenance. Wash the lid and vent cap in warm, soapy water, then rinse and dry thoroughly. Wipe the popcorn maker main unit with a soft, damp cloth and allow to dry thoroughly. Do not use harsh or abrasive detergents or scourers to clean the popcorn maker, as this could cause damage.

The popcorn maker is not suitable for use in a dishwasher. Always clean the popcorn maker immediately after each use.

Instructions for use

Before first use

Before using the popcorn maker for the first time, clean it following the instructions in the section entitled '**Care and maintenance**'.



NOTE: When using the popcorn maker for the first time, a slight odour may be emitted. This is normal and will soon subside. Allow for sufficient ventilation around the popcorn maker.

Using the popcorn maker

STEP 1: Place the popcorn maker main unit onto a flat, stable surface, at a height that is comfortable for the user. Add approx. 1 tbsp of vegetable oil to the cooking plate.

STEP 2: Put one large measuring spoon of popcorn onto the cooking plate. Do not use more than 75 g of kernels, as this will overfill the popcorn maker and could result in damage.

STEP 3: Place the lid onto the popcorn maker main unit, ensuring the handles on the lid are aligned with the handles on the popcorn maker main unit. Ensure the vent cap has been removed from the lid.

STEP 4: Plug in and switch on the popcorn maker at the mains power supply. Turn on the popcorn maker using the on/off switch. The cooking plate will begin to heat up and the rotating stirrer will begin to slowly rotate in a clockwise direction.

It will take approx. 6 minutes for all of the popcorn kernels to pop, depending on the quantity of kernels used.

STEP 5: When all of the popcorn is made, turn off the popcorn maker using the on/off switch and unplug it from the mains power supply.

STEP 6: Place the vent cap on the lid. Hold the popcorn maker and lid by the handles and flip upside down. Place the popcorn maker back on to a stable surface and lift away the main unit. Allow the popcorn maker to cool for approx. 10 minutes before using it again.



NOTE: Approx. 25 g of kernels is 1 serving.